



460 Southport Commerce Blvd.  
 Spartanburg SC 29306  
 Phone: 864-574-6004  
 Fax: 864-574-6005  
 www.ojedausa.com  
 sales@ojedausa.com

Project: \_\_\_\_\_  
 Model #: \_\_\_\_\_  
 Item #: \_\_\_\_\_ Qty: \_\_\_\_\_  
 Approval: \_\_\_\_\_

# GLASS DOOR MERCHANDISER

# RMH-33PT



### STEEL CONSTRUCTION

Robust steel construction minimizes the use of plastic materials resulting in an environmentally friendly design.

### CARE FREE CONDENSER

The finless spiral condenser design prevents dust/dirt buildup allowing maximum long term efficiency.

### PASS THROUGH DUAL DOORS

Self closing double pane sliding glass doors come with door-holding feature. Doors stay open without having to be held, allowing for convenient merchandise stocking.

### LED LIGHTING

LED lighting lasts longer than fluorescent lighting, it reducing energy consumption, which generates minimal heat. All of this makes LED lighting great for the environment.

### HOT GAS EVAPORATION

Hot gas heated drain pan for condensate evaporation that eliminates the need of floor drains or electric heaters.

### OPERATION TEMPERATURE

33°F to 38°F

### CUSTOM GRAPHICS

Standard color: black.

Dimensions			Crated Dimensions				Shelves	HP	Voltage	NEMA config	Amps	Crated Weight	
	W	D	H		W	D	H	3	1/3	120	5-15P	3.5	345 lbs
(in)	39.7	28.5	56.7	(in)	42.2	29.7	59.7	Net Capacity (cf): 14			Energy Consumption: 2.09 kw-hr/24 hrs		
(mm)	1007	724	1440	(mm)	1072	754	1516						

\*Inches rounded up one decimal place \*Specifics may change without notification



## CABINET CONSTRUCTION

- High-density, CFC-Free, polyurethane insulation.
- Exterior: Galvanized metal cabinet with powder coated painted surface
- Interior: Easy to clean pre-painted steel.

## REFRIGERATION

- Maintenance free condenser
- Automatic defrost cycle
- Hot gas heated pan for condensate evaporation
- Easy to reach components for maintenance
- R-134A refrigerant

## LIGHTING

- LED horizontal and vertical lighting

## OPERATING CONDITIONS

- The unit is rated for an environment where temperatures remain below 75°F and humidity does not exceed 55%
- Areas with direct sunlight should also be avoided

## SHELVING

- 3 Adjustable wire shelves (31.9" x 19.25")

## ACCESSORIES

- 6" adjustable stainless steel legs
- Heavy duty casters 3" and 5"
- Shelf product organizer
- Custom graphics

## WARRANTY

- 2 year parts and labor warranty
- 5 year compressor

## LED LIGHTING



## DOOR HOLD FEATURE

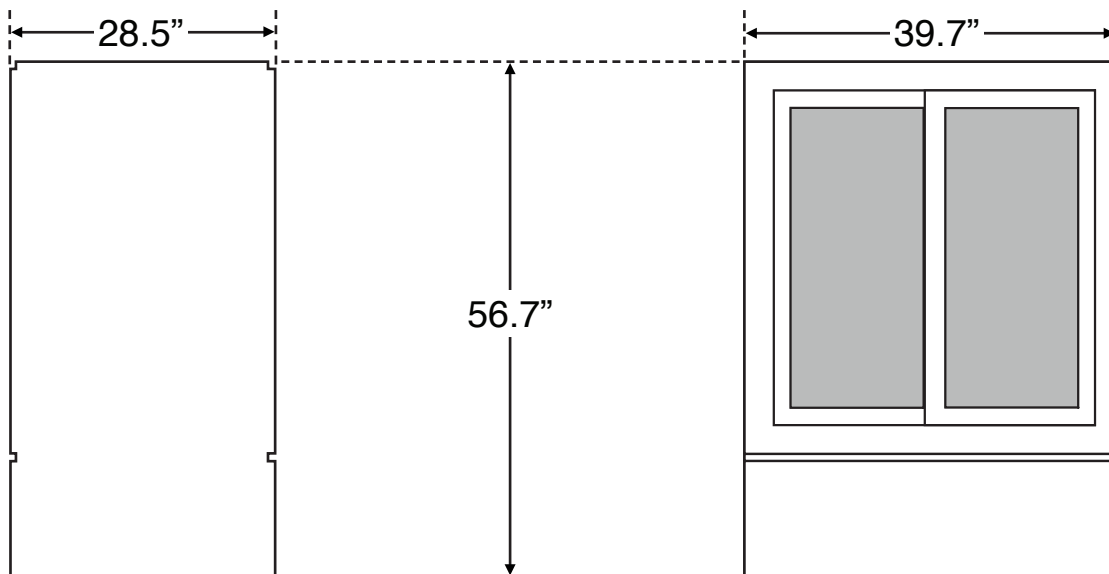

\*Specifics may change without notification

